



Wave Cyber



**4" MEMBRANE PRESSURE VESSEL SPARE PART LIST
SIDE PORT AND END PORT**

Table of Contents
1) Individual Components

A) SIDE PORT VESSEL COMPONENTS ONLY.....	1-3
I) PERMEATE PORTS	1
II) SIDE PORT PARTS – GENERATION 3	1
- Side Port.....	1
- Side Port Seal.....	1
- Side Port Gasket Seal.....	1
- Side Port Retaining Ring.....	1
- Clasp.....	1
- Clasp Cover.....	1
III) SIDE PORT PARTS – GENERATION 2.....	2
- Side Port.....	2
- Side Port Seal.....	2
- Side Port Gasket Seal.....	2
- Side Port Retaining Ring.....	2
- Retaining Ring.....	2
IV) SIDE PORT PARTS – GENERATION 1.....	2
- Side Port.....	2
- Side Port Seal.....	2
- Side Port Retaining Ring.....	2
- Retaining Ring.....	2
V) ADAPTOR.....	3
- Adaptor.....	3
- Adaptor Seal.....	3
B) END PORT VESSEL COMPONENTS ONLY.....	3
I) PERMEATE PORTS	3
C) SIDE PORT & END PORT VESSELS COMMON PARTS.....	4
I) BAFFLES & BAFFLE SCREWS.....	4
II) HEAD SEAL.....	4
III) PERMEATE PORT PARTS.....	4
IV) SADDLE PARTS.....	4
- Saddle.....	4
- Strap & Strap Nut.....	4
- Strap Screw.....	4
- Strap Protective Jacket.....	4

2) Spare Parts Kit Options

A) SIDE PORT VESSEL KITS ONLY.....	5-6
I) COMPLETE HEAD ASSEMBLY KIT	5
- Permeate Port	
- Baffles	
- Baffle Screws	
- Head Seal	
- MPV Seal	
II) COMPLETE MPV SEAL/RETAINING RING KITS.....	5
- Side Port Curved Seal – Generation 1	
- Side Port Seal – Generation 2	

4" Membrane Pressure Vessel – Spare Parts List (300/450 PSI)

- Side Port Gasket Seal – Generation 2
- Retaining Ring
- Clasp & Clasp Cover
- Head Seal & MPV Seal

III) SIDE PORT KITS (ENOUGH FOR 1 SIDE PORTS PER VESSEL).....6

- Side Port Curved Seal – Generation 1
- Side Port Seal – Generation 2
- Side Port Gasket Seal – Generation 2
- Side Port Retaining Ring
- Retaining Ring
- Clasp & Clasp Cover



B) END PORT VESSEL KITS ONLY..... 6
I) COMPLETE HEAD ASSEMBLY KIT 6

- Permeate Port
- Baffle
- Baffle Screws
- Head Seal
- MPV Seal

C) SIDE PORT & END PORT VESSELS COMMON KITS
I) Saddle Kit.....7

- Saddle
- Strap
- Strap Nut
- Strap Screw
- Strap Protective Jacket

4" Membrane Pressure Vessel – Spare Parts List (300/450 PSI)
1. Individual Components
A. Side Port Vessel Components Only
I. Permeate Ports

	Pressure	Type	Part No.
	300P	Option P NPT Female thread 1/2"	10300
		Option R BSPP Female thread 1/2"	10307-1
		Option S BSPT Female thread 1/2"	10308-1
	450P	Option P NPT Female thread 1/2"	10309
		Option R BSPP Female thread 1/2"	10310
		Option S BSPT Female thread 1/2"	10311

II. Side Port Parts – Generation 3

Side Port (SS316L)



	Q (1")	K (1")
		NPT3/4"
	Part No.	Part No.
300P	20165	20391
450P	20166	20392

Side Port Seal (EPDM)



	Q (1")	K (1")
	Part No.	Part No.
300P/450P	10616	10616

Side Port Gasket Seal (EPDM)



	Q (1")	K (1")
	Part No.	Part No.
300P/450P	10617	10617

Side Port Retaining Ring (SS316)



	Q (1")	K (1")
	Part No.	Part No.
300P/450P	20122	20122

Clasp (SS316)



	Q (1")	K (1")
	Part No.	Part No.
300P/450P/ 1000P	20692	20692

Clasp Cover (SS316)



	Q (1")	K (1")
	Part No.	Part No.
300P/450P/ 1000P	20693	20693

III. Side Port Parts – Generation 2

Side Port (SS316L)



	Q (1")	K (1")
		NPT3/4"
	Part No.	Part No.
300P	20165	20391
450P	20166	20392

Side Port Seal (EPDM)



	Q (1")	K (1")
	Part No.	Part No.
300P/450P	10616	10616

Side Port Gasket Seal (EPDM)



	Q (1")	K (1")
	Part No.	Part No.
300P/450P	10617	10617

Side Port Retaining Ring (SS316)



	Q (1")	K (1")
	Part No.	Part No.
300P/450P	20122	20122

Retaining Ring (SS316)



	Q (1")	K (1")
	Part No.	Part No.
300P/450P/ 1000P	20169	20169

IV. Side Port Parts – Generation 1

Side Port (SS316L)



	Q (1")	K (1")
		NPT3/4"
	Part No.	Part No.
300P	20165	20391
450P	20166	20392

Side Port Seal (EPDM)



	Q (1")	K (1")
	Part No.	Part No.
300P/450P	10171-1	10171-1

Side Port Retaining Ring (SS316)



	Q (1")	K (1")
	Part No.	Part No.
300P/450P	20122	20122

Retaining Ring (SS316)



	Q (1")	K (1")
	Part No.	Part No.
300P/450P/ 1000P	20169	20169

V. Adaptor

Adaptor (ABS)



	W/Hole	W/O Hole
	Part No.	Part No.
F 0.75"	10148	10368



M 0.625"	10388	10369
----------	-------	-------



日东电工	10659	10660
------	-------	-------

Adaptor Seal (EPDM)



	Part No.
F 0.75"	10178
M 0.625"	10389
日东电工	10625

B. End Port Vessels Only Components

I. Permeate Ports



	Pressure	Type	Part No.
300P	Option BP	NPT 1/2" NPT3/4"	10253
	Option AP	NPT 1/2" NPT 1/2"	10254
	Option DR	BSPP 1/2" BSPP 3/4"	10255
	Option CR	BSPP 1/2" BSPP 1/2"	10256
	Option ES	BSPT 1/2" BSPT 1/2"	10257
	Option FS	BSPT 1/2" BSPT 3/4"	10258
	Option HT	BSPP 1/2" BSPP 3/4"	10428-1
	Option GT	BSPP 1/2" BSPP 1/2"	10429-1
450P	Option BP	NPT 1/2" NPT3/4"	10301
	Option AP	NPT 1/2" NPT 1/2"	10302
	Option DR	BSPP 1/2" BSPP 3/4"	10303
	Option CR	BSPP 1/2" BSPP 1/2"	10304
	Option ES	BSPT 1/2" BSPT 1/2"	10305
	Option FS	BSPT 1/2" BSPT 3/4"	10306
	Option HT	BSPP 1/2" BSPP 3/4"	10505
	Option GT	BSPP 1/2" BSPP 1/2"	10506

C. Side Port and End Port Vessels Common Parts

I. Baffles and Baffle Screws

Baffles (304)



300P/450P	Part No.
	20017

Baffle Screws (SS)



300P/450P	Part No.
	20127

II. Head Seal

Head Seal (EPDM)



All Pressure	Part No.
	10177

III. Permeate Port Parts

MPV Seal (EPDM)



300P/450P	Part No.
	10178

IV. Saddle Parts

Saddle (TPU)

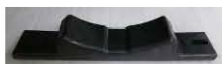

All pressure	Part No.
	10140

Strap (304)



All pressure	Part No.
	20124

Strap Nut (Hpb51-9)



All pressure	Part No.
	20124

Strap Screw (SS)



All pressure	Part No.
	20128

Strap Protective Jacket (Soft PVC)



All pressure	Part No.
	10189

2. Spare Parts Kit Option

A. Side Port Vessels Only Kits

I. Complete Head Assembly

- Permeate Port
- Baffles
- Baffle Screws
- Head Seal
- MPV Seal

Permeate Port	Baffles (20017)	Baffle Screws (20127)	Head Seal (10177)	MPV Seal (10178)
				

Pressure Rating	300P	450P
Complete head assembly	<u>Kits Code</u>	<u>Kits Code</u>
P	10634	10635
R	10636	10637
S	10638	10639

II. Complete MPV Seal/Retaining Ring Kits

- Side Port Curved Seal – Generation 1
- Side Port Seal – Generation 2
- Side Port Gasket Seal – Generation 2
- Retaining Ring
- Clasp & Clasp Cover
- Head Seal & MPV Seal

Size	Side Port Seal Kits-300P/450P			
	Kits code	Part No. & Description		QTY
1"	11176	10171-1	Side Port Curved Seal - Generation 1	4
		10616	Side Port Seal - Generation 2	4
		10617	Side Port Gasket Seal - Generation 2	4
		20122	Side Port Retaining Ring	4
		20169	Retaining Ring	4
		20692	Clasp	4
		20693	Clasp Cover	4
		10177	Head Seal	2
		10178	MPV Seal	2
		Part Identification Sheet		

III. *Side Port Kits* (Enough for one side port only)

Size	Side Port Seal Kits			
	Kits code	Part No. & Description		QTY
1"	20698	10171-1	Side Port Curved Seal - Generation 1	1
		10616	Side Port Seal - Generation 2	1
		10617	Side Port Gasket Seal - Generation 2	1
		20122	Side Port Retaining Ring	1
		20169	Retaining Ring	1
		20692	Clasp	1
		20693	Clasp Cover	1

B. End Port Vessels Only Kits

I. *Complete Head Assembly*

- **Permeate Port**
- **Baffles**
- **Baffle Screws**
- **Head Seal**
- **MPV Seal**

Permeate Port	Baffles (20017)	Baffle Screws (20127)	Head Seal (10177)	MPV Seal (10178)
				

Pressure Rating	300P	450P
Complete Head Assembly	<u>Kits Code</u>	<u>Kits Code</u>
AP	10640	10641
BP	10642	10643
CR	10644	10645
DR	10646	10647
ES	10648	10649
FS	10626	10627
HT	10628	10630
GT	10629	10631

C. Side Port and End Port Vessels Common Kits

I. *Saddle Kits*

Saddle Kit Options

	<u>Part No.</u>
Saddle	10140
Strap & Strap Nut	20124
Strap Screw	20128
Strap Protective Jacket	10189
Complete Saddle Kit	20277



CONTACT US

Tel: (440) 510-0546

Fax: (440) 510-0550

P.O. Box 515

Chardon, OH 44024

www.wave-cyber.com